

# Aspri 15 Surface horizontal



## Centrifugal multistage pump for water supply, self-priming up to 9m

### Applications

Pumping of clean water for domestic, industrial, agricultural and gardening purposes.  
Silent.  
Self-priming up to 9m.

### Motor

Asynchronous 2 poles.  
IPX5 protection.  
Class F insulation.  
Single phase motor with built-in thermal protection.  
Continuous operation.

### Materials

Pump body and impellers in AISI 304.  
Pump shaft in AISI 431.  
Diffusers in technopolymer.  
Suction and discharge in cast iron with cataphoresis coating.  
Mechanical seal in aluminium-graphite.  
Motor casing in aluminium.  
O-rings in NBR/EPDM.

### Limitations

Maximum water temperature: 40° C.

### Equipment

No cable.



### Hydraulic performance table

Model	I [A]			P1 [kW]		P2		c [μF]	l/min m³/h	10	20	30	35	40	50	60	65	Code	
	1~230V	3~230V	3~400V	1~	3~	[kW]	[HP]			0,6	1,2	1,8	2,1	2,4	3,0	3,6	3,9	1~230V	3~230V/400V
Aspri 15 2	2	-	-	0,45	-	0,24	0,33	12	mwc	21	20	17	16	14	11	7	5	96410	-
Aspri 15 3	2,7	2,1	1,2	0,61	0,61	0,37	0,5	12		32	30	26	24	22	17	11	7	96415	96412
Aspri 15 4	3,5	2,3	1,3	0,79	0,79	0,55	0,75	12		43	39	35	32	27	22	14	9	96423	96421
Aspri 15 5	4,1	3,3	1,9	0,95	0,95	0,75	0,9	12		51	47	42	38	34	25	17	12	96432	96430

### Performance curve at 2900 rpm

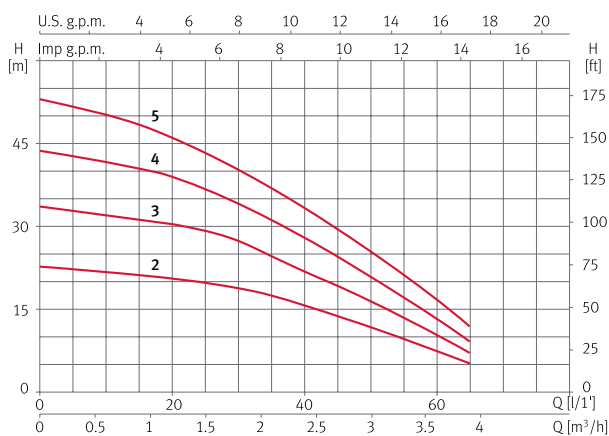

### Dimension and weight

Model	A	B	C	D	E	F	G	H	I	J	Kg
Aspri 15 2	163	213	202	110	74	162	121	102	1"	1"	8,3
Aspri 15 3	187	237	202	110	74	162	121	102	1"	1"	9,2
Aspri 15 4	211	261	202	110	74	162	121	102	1"	1"	10
Aspri 15 5	235	285	202	110	74	162	121	102	1"	1"	11

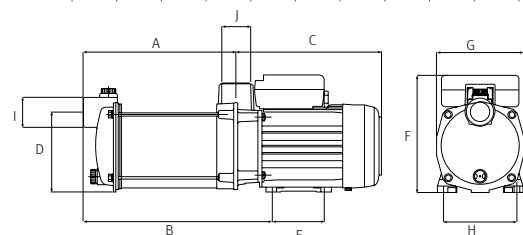

# Aspri 25 Surface horizontal



## Centrifugal multistage pump for water supply, self-priming up to 9m

### Applications

Pumping of clean water for domestic, industrial, agricultural and gardening purposes.  
Silent.  
Self-priming up to 9m.

### Materials

Pump body and impellers in AISI 304.  
Pump shaft in AISI 431.  
Diffusers in technopolymer.  
Suction and discharge in cast iron with cataphoresis coating.  
Mechanical seal in aluminium-graphite.  
Motor casing in aluminium.  
O-rings in NBR/EPDM.

### Equipment

No cable.

### Motor

Asynchronous 2 poles.  
IPX5 protection.  
Class F insulation.  
Single phase motor with built-in thermal protection.  
Continuous operation.

### Limitations

Maximum water temperature: 40° C.



### Hydraulic performance table

Model	I [A]			P1 [kW]		P2		c [μF]	l/min	15	30	45	60	75	90	105	120	Code	
	1~230V	3~230V	3~400V	1~	3~	[kW]	[HP]			m³/h	0,9	1,8	2,7	3,6	4,5	5,4	6,3	7,2	1~230V
Aspri 25 3	5,5	3,5	2	1,2	1	0,75	1	16	mwc	33	32	31	28	26	22	17	12	96450	96447
Aspri 25 4	6,8	4,3	2,5	1,5	1,4	0,9	1,2	16		43	42	40	37	33	28	22	15	96458	96455
Aspri 25 5	7,4	5,2	3	1,7	1,7	1,1	1,5	25		56	55	53	48	43	37	29	20	96466	96464

### Performance curve at 2900 rpm

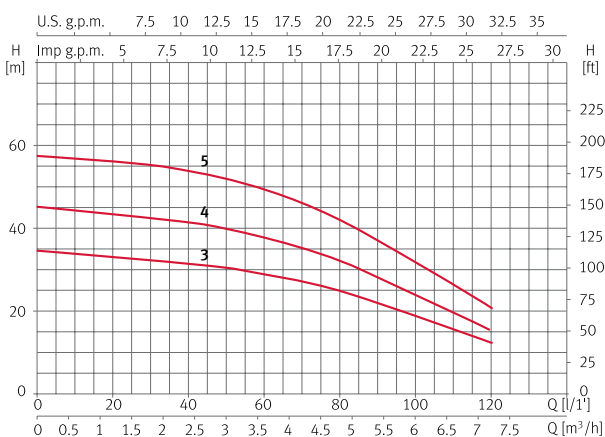

### Dimension and weight

Model	A	B	C	D	E	F	G	H	I	J	L/M	Kg
Aspri 25 3	202	127	253	82	75	110	218	59	138	8	1"	13,5
Aspri 25 4	229	127	279	82	75	110	218	59	138	8	1"	14,6
Aspri 25 5	255	127	328	82	90	122	241	59	138	8	1"	17,2

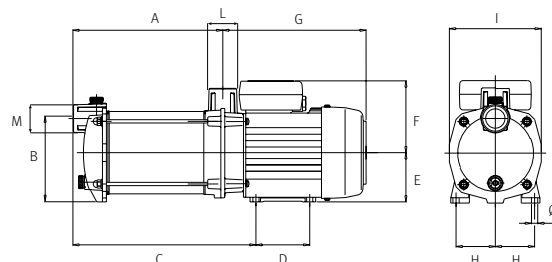

# Aspri 35N Surface horizontal



Centrifugal multistage pump for water supply, self-priming up to 9m

### Applications

Pumping of clean water for domestic, industrial, agricultural and gardening purposes.  
Silent.  
Self-priming up to 9m.

### Materials

Pump body and impellers in AISI 304.  
Pump shaft in AISI 431.  
Diffusers in technopolymer.  
Suction and discharge in cast iron with cataphoresis coating.  
Mechanical seal in aluminium-graphite.  
Motor casing in aluminium.  
O-rings in NBR/EPDM.

### Equipment

No cable.

### Motor

Asynchronous 2 poles.  
IPX5 protection.  
Class F insulation.  
Single phase motor with built-in thermal protection.  
Continuous operation.

### Limitations

Maximum water temperature: 40° C.



### Hydraulic performance table

Model	I [A]			P1 [kW]		P2		c [μF]	l/min m³/h	20	40	60	80	100	120	140	150	Code	
	1~230V	3~230V	3~400V	1~	3~	[kW]	[HP]											1~230V	3~230V/400V
Aspri 35 3N	6,7	4,5	2,6	1,5	1,4	0,75	1	25	mwc	41	39	36	34	31	27	22	18	129699	129696
Aspri 35 4N	8,4	5,3	3,1	1,8	1,8	1,1	1,5	25		54	51	48	44	39	33	27	23	129700	129697
Aspri 35 5N	10,2	6,9	4	2,3	2,2	1,5	2	30		68	64	60	55	49	41	34	30	129701	129698
Aspri 35 6N	-	8,3	4,8	-	2,7	2,2	3	-		81	78	74	67	60	52	42	37	-	130368

### Performance curve at 2900 rpm

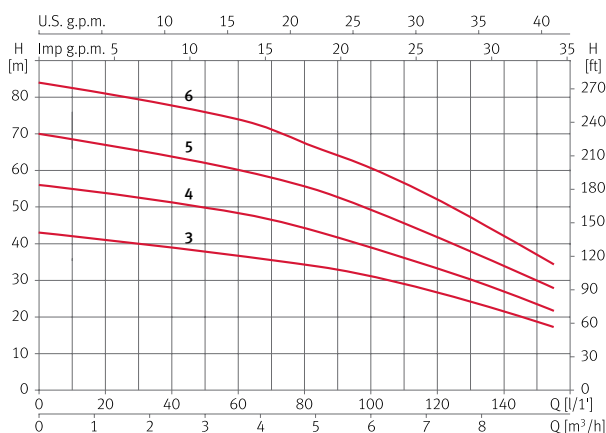

### Dimension and weight

Model	A	B	C/E	D	F	G	H	I	J	K	Kg
Aspri 35 3N	221	187	1 1/4"	147	282	158	122	90	60	12	18,5
Aspri 35 4N	247	212	1 1/4"	147	282	158	122	90	60	12	20,5
Aspri 35 5N	271	236	1 1/4"	147	282	158	122	90	60	12	23,5
Aspri 35 6N	296	261	1 1/4"	147	282	158	122	90	60	12	23,7

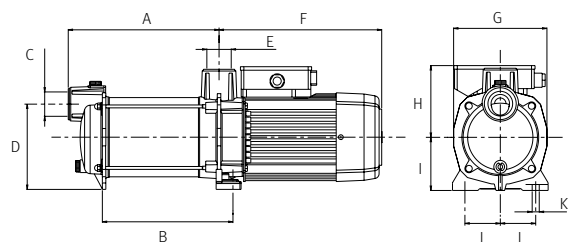

# Aspri 45N Surface horizontal



## Centrifugal multistage pump for water supply, self-priming up to 9m

### Applications

Pumping of clean water for domestic, industrial, agricultural and gardening purposes.  
Silent.  
Self-priming up to 9m.

### Materials

Pump body and impellers in AISI 304.  
Pump shaft in AISI 431.  
Diffusers in technopolymer.  
Suction and discharge in cast iron with cataphoresis coating.  
Mechanical seal in aluminium-graphite.  
Motor casing in aluminium.  
O-rings in NBR/EPDM.

### Equipment

No cable.

### Motor

Asynchronous 2 poles.  
IPX5 protection.  
Class F insulation.  
Single phase motor with built-in thermal protection.  
Continuous operation.

### Limitations

Maximum water temperature: 40° C.



### Hydraulic performance table

Model	I [A]			P1 [kW]		P2		c [μF]	l/min m³/h	Flow rate								Code	
	1~230V	3~230V	3~400V	1~	3~	[kW]	[HP]			25	50	75	100	125	150	200	250	1~230V	3~230V/400V
Aspri 45 3N	7,9	5,2	3	1,8	1,7	1,1	1,5	25	37	36	35	33	30	27	18	8	132087	132089	
Aspri 45 4N	10	6,9	4	2,2	2,2	1,5	2	30	48	47	45	42	39	36	24	11	132088	132090	
Aspri 45 5N	-	8,6	5	-	2,8	2,2	3	-	61	59	56	54	50	45	31	15	-	132091	

### Performance curve at 2900 rpm

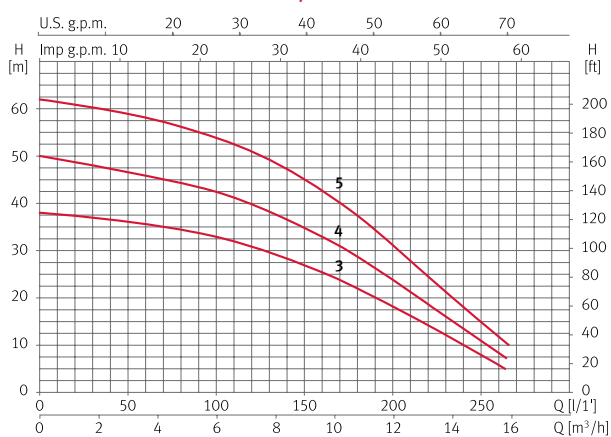

### Dimension and weight

Model	A	B	C	D	E	F	G	H	I	J	K	Kg
Aspri 45 3N	246	212	1 1/2"	147	1 1/4"	282	158	128	90	60	12	22,6
Aspri 45 4N	277	242	1 1/2"	147	1 1/4"	282	158	128	90	60	12	23,7
Aspri 45 5N	307	273	1 1/2"	147	1 1/4"	282	158	128	90	60	12	25,3

